



7 Haywards Farm Close , Verwood, BH31 6XW

Dating back to the early 1700s, this exceptional period home is recognised as one of the oldest surviving properties in Verwood, offering a rare blend of historic character, generous accommodation and modern versatility.

Set within a quiet and desirable location, the main house provides substantial and flexible living space arranged over two floors, currently configured to offer five to six bedrooms, making it ideal for larger families, multi-generational living or those seeking space to work from home.

At the heart of the home is a welcoming lounge featuring a traditional fire box and wood-burning stove, creating a warm and atmospheric focal point. Throughout the property, original features reflect the building's heritage while being carefully balanced with practical updates for modern living.

Asking Price £675,000

7 Haywards Farm Close

, Verwood, BH31 6XW



- 1700 Period Detached Property
- Detached Double Garage
- Utility Area With Built In Storage Cupboards
- Master Bedroom With Ensuite
- Two Reception Rooms With Log Burners
- Annexe/Guest House
- Large Garden With Hot Tub
- Driveway
- Desirable Location
- Call To Enquire 01202 117288



Directions



Floor Plan

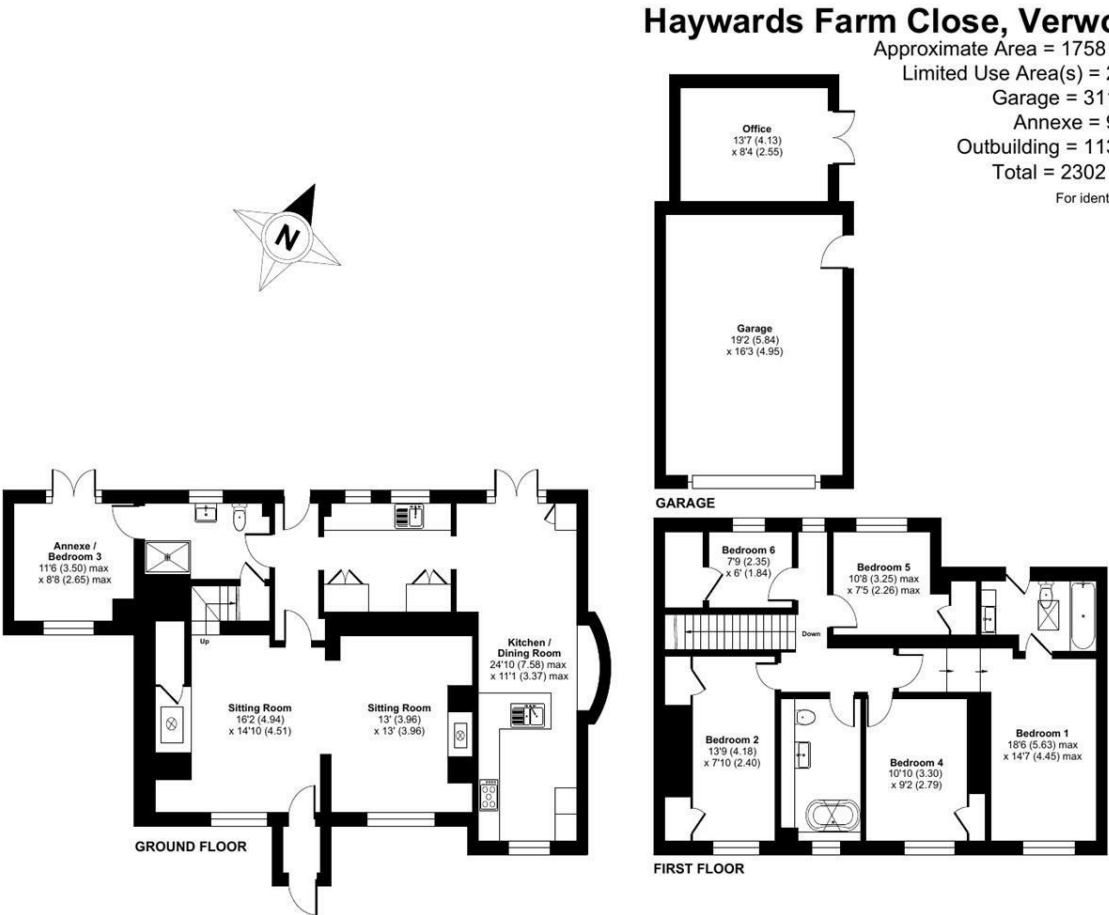

Haywards Farm Close, Verwood, BH31

Approximate Area = 1758 sq ft / 163.3 sq m
Limited Use Area(s) = 24 sq ft / 2.2 sq m
Garage = 311 sq ft / 28.8 sq m
Annexe = 96 sq ft / 8.9 sq m
Outbuilding = 113 sq ft / 10.4 sq m
Total = 2302 sq ft / 213.6 sq m
For identification only - Not to scale

Floor plan produced in accordance with RICS Property Measurement 2nd Edition, Incorporating International Property Measurement Standards (IPMS2 Residential). © nchecom 2026. Produced for Keller Williams (360 Properties). REF: 1400760

These particulars, whilst believed to be accurate are set out as a general outline only for guidance and do not constitute any part of an offer or contract. Intending purchasers should not rely on them as statements of representation of fact, but must satisfy themselves by inspection or otherwise as to their accuracy. No person in this firms employment has the authority to make or give any representation or warranty in respect of the property.

